

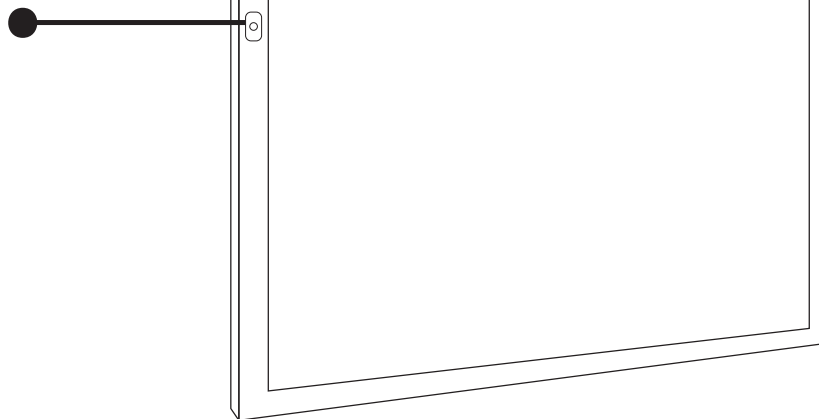

# LED Panel Light Backlit with PIR Sensor Base Pre-Select 3 Wattage Pre-Select 3 CCT 3500K-4000K-5000K

**SKU#123000**  
**123001**  
**123002**

**PIR Sensor Base  
(PIR Sensor is Optional)**



## Safety Information

**⚠ CAUTION! Risk Of Electrical Shock**

**⚠** Turn off main power prior to installation by switching off circuit breaker.

- This product should be installed by a certified electrician in accordance with relevant federal, state and local building and electrical codes

## Common Failures & Solutions

| Common Failures | Solutions                           |
|-----------------|-------------------------------------|
| Light is out    | Ensure the light is well connected. |
|                 | Ensure the switch is turned on.     |
| Flashing        | Ensure the voltage is stable.       |
|                 | Ensure the dimmer is compatible.    |

## Size

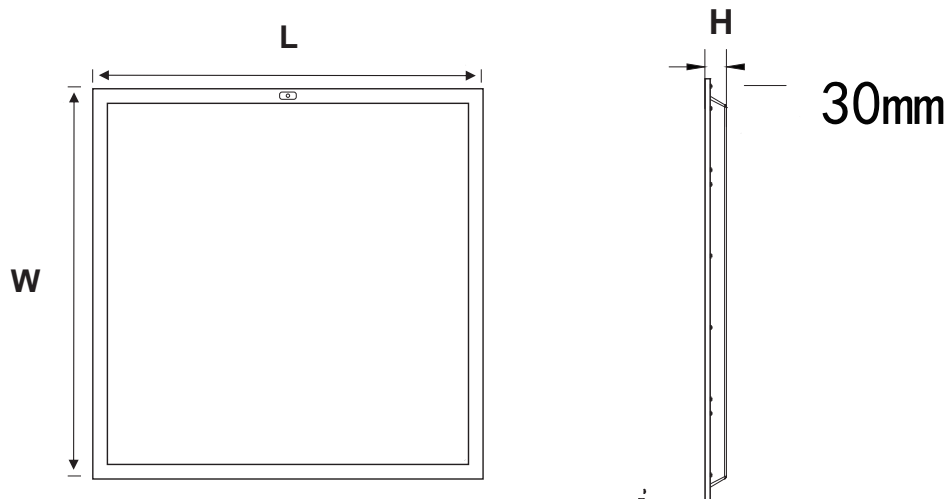

| SIZE              | L X W X H (mm)            | L X W X H (Inch)           |
|-------------------|---------------------------|----------------------------|
| <b>2FT X 2 FT</b> | <b>602 X 602 X 30 mm</b>  | <b>23.7 X 23.7 X 1.2"</b>  |
| <b>1FT X 4 FT</b> | <b>298 X 1209 X 30 mm</b> | <b>11.74 X 47.6 X 1.2"</b> |
| <b>2FT X 4 FT</b> | <b>602 X 1209 X 30 mm</b> | <b>23.7 X 47.6 X 1.2"</b>  |

# Wiring

1. The dimming wire DIM+ (Purple) and the sensor DIM+ (Purple) are connected;
2. The dimming wire DIM-(Pink) and the sensor DIM-(Pink) are connected;
3. The power supply 12V+ (Red) and 12V+ (Yellow) is connected;
4. Power supply AC-L (Black) and external input L need to be connected;
5. AC-N(White) and external input N need to be connected.

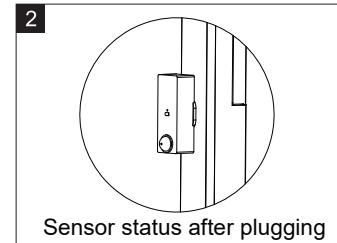
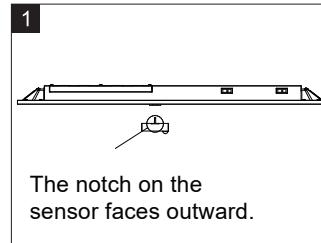
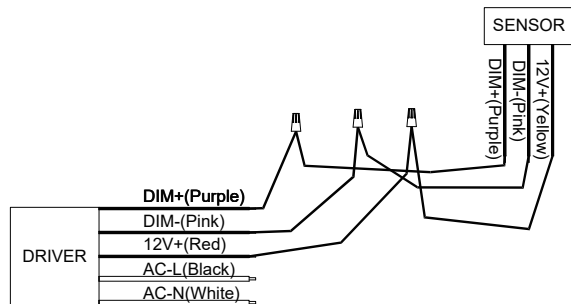

# Installation

## Recession

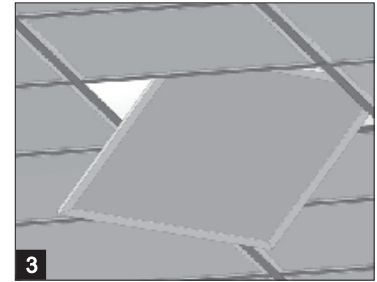
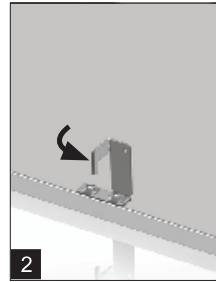
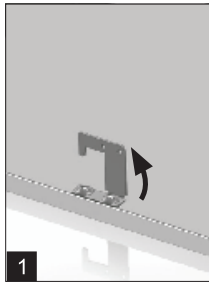

## Suspension

(Optional Accessories)

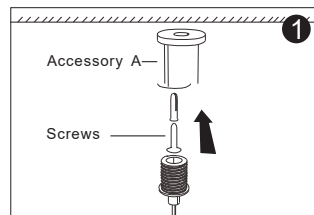

1. Screwing Accessory A in the ceiling.

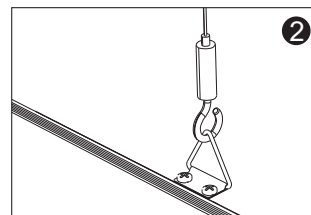

2. Triangle rings for hooks.



3. Finish the installation.

# Notes

1. Indoor lighting only.
2. Before installation, ensure the LED panel is not damaged.
3. Don't stare at the LED luminous surface for long time.
4. Keep away from children, and ensure working electrical apparatus inaccessible to them.
5. No packages accessible to children, because they might be choked for playing, or eating the small accessories.
6. No covering, be away from fire or high-temperature substances.
7. Manufacturer reserves the right to offer no replacement or warranty to the LED panels disassembled or repaired by users themselves.
8. Cut off power before cleaning the panels with dry cloth, use no chemical or corrosive substances.
9. Cut off power before installation.
10. The light source of this luminaire is not replaceable. When the light source reaches its end of life, the whole luminaire shall be replaced.

# Surfaced mounted

(Optional Accessories)

## ● Surfaced Mounted Frame

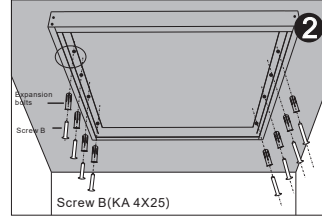
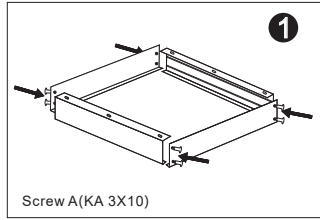
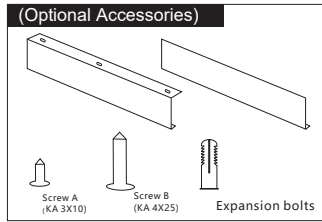

1. Assemble the four frames with Screw A to a whole square.

2. Fix the square frames to the ceiling with Screw B.

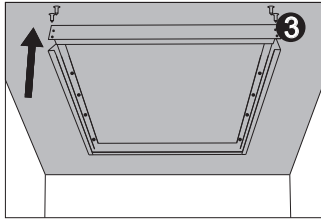

3. Demount one frame.

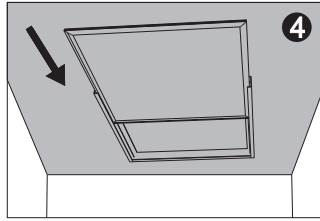

4. Put the panel into the frame square.

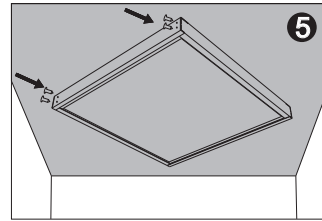

5. Fix the last frame with screw A.

# Recessed Frame

(Optional Accessories)

## ● Recessed Frame

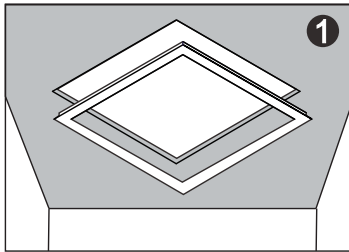

1. Put the frame into the hole.

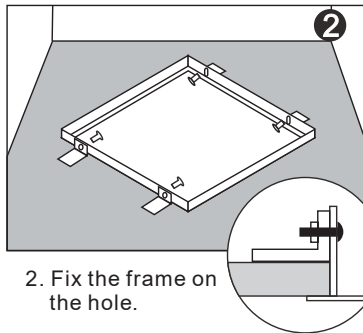

2. Fix the frame on the hole.

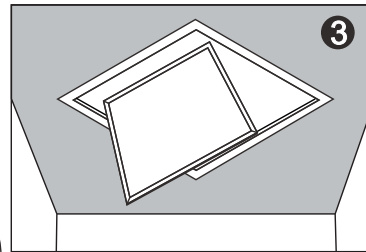

3. Put the panel into the recessed mounted frame.

## FCC Notes

This device complies with Part 15 of the FCC Rules. Operation is subject to the following two conditions: (1) This device may not cause harmful interference, and (2) this device must accept any interference received, including interference that may cause undesired operation.

Changes or modifications to this unit not expressly approved by the party responsible for compliance could void the user's authority to operate the equipment.

NOTE: This equipment has been tested and found to comply with the limits for a Class B digital device, pursuant to Part 15 of the FCC Rules. These limits are designed to provide reasonable protection against harmful interference in a residential installation. This equipment's production and uses can radiate radio frequency energy and, if not installed and used in accordance with the instructions, may cause harmful interference to radio communications. However, there is no guarantee that interference will not occur in a particular installation. If this equipment does cause harmful interference to radio or television reception, which can be determined by turning the equipment off and on, the user is encouraged to try to correct the interference by one or more of the following measures:

- Reorient or relocate the receiving antenna.
- Increase the separation between the equipment and receiver.
- Connect the equipment into an outlet on a circuit different from that to which the receiver is connected.
- Consult the dealer or an experienced radio/ TV technician for help.