

Installation Instruction

Wall Pack

Pre-Select 3 Wattage & 3 CCT Series



READ CAREFULLY BEFORE INSTALLING FIXTURE. RETAIN THESE INSTRUCTIONS FOR FUTURE REFERENCE.

- DANGER-Risk of shock -Turn off electrical power before wiring.
- All electrical connection must be in accordance with local National Electrical Code(N.E.C) standards.
- Products are not intended for use in environments containing airborne corrosive agents chemical such as chemical solvents, cleaners or cutting fluids.
- Suitable for outdoor Wet locations.
- Min 70 °C SUPPLY CONDUCTORS.
- Operating in ambient temperature not exceeding 40°C (104°F)
- This Fixture is rated for120-347Vac 50/60Hz only.
(Please check the label for detail input voltage)
- If the product is damaged, do not use it.

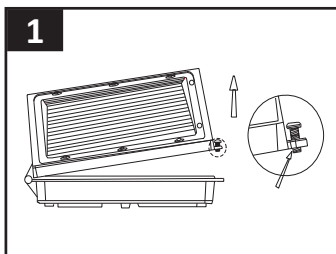

Using a screwdriver loosen side Housing Screws.

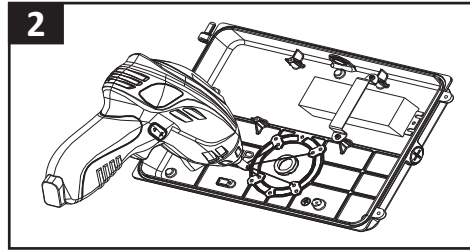

Remove the Housing Back Plate and unscrew center Plug, using a drill open installation holes in Housing Back Plate.

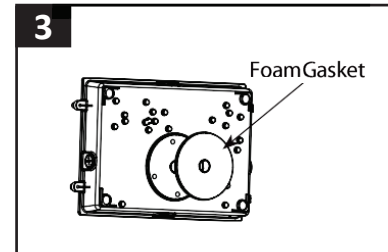

Apply Foam Gasket (provided) to external surface of the Housing Back Plate.

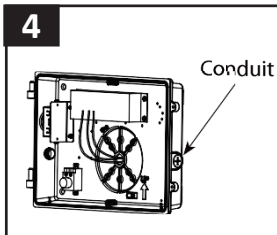

Feed supply wires through Housing Back Plate center Plug. Connect Wiring.

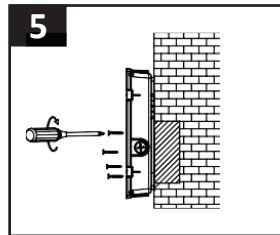

Secure Housing Back Plate to surface or junction box with Screws (supplied by others).

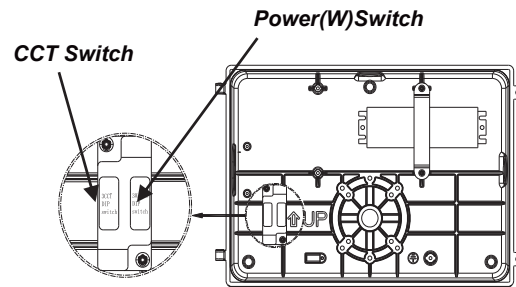

Turn off power before switching

Please choose the power and color temperature.

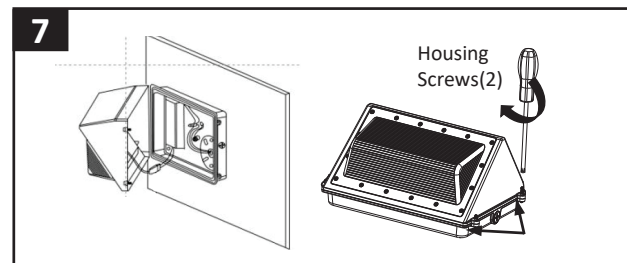
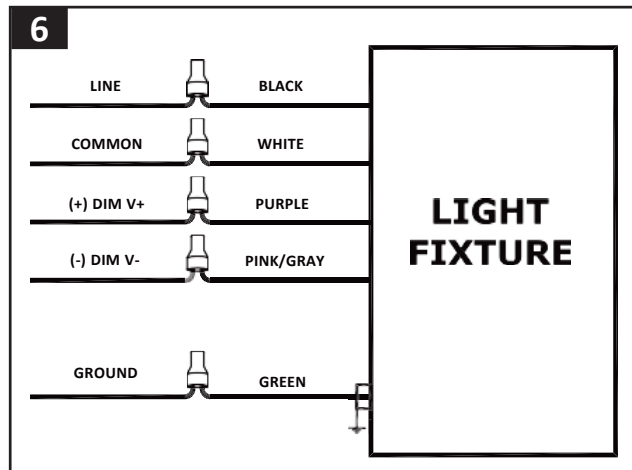

Make connections LED Driver to LED Modules and Mount the Housing over the Housing Back Plate and secure with (2) Screws (provided).

Wire the Housing leads to supply wires using UL listed wire connectors according to NEC and local codes.